

MT. SAN ANTONIO COLLEGE

Athletic
SPECIAL EVENTS
EMERGENCY SERVICES GUIDE



PREPARED BY THE:
DIVISION OF PHYSICAL EDUCATION
MT. SAN ANTONIO COLLEGE

UPDATED MARCH 25, 2009

BILL ITO
MEDICAL COORDINATOR

T A B L E O F C O N T E N T S

PAGE	CONTENT
1	GENERAL INFORMATION
2	SPECIAL EVENTS STAFF
3	STADIUM SCHEMATIC
4	FREEWAY MAP
5	CAMPUS MAP
6	EMERGENCY INFORMATION
7	SERVICES INFORMATION (Hotels, Car Rental, Supermarkets, Shopping Malls)
8	SERVICES INFORMATION (Restaurants)

GENERAL INFORMATION

MT. SAN ANTONIO COLLEGE

ADDRESS	1100 NORTH GRAND AVENUE • WALNUT, CA 91789
GENERAL COLLEGE NUMBER	909.594.5611
PE DIVISION EXTENSION	4630
CAMPUS SECURITY	909.594.5611 ext. 4233, 4299 or 4555
WEB ADDRESS	www.mtsac.edu
ATHLETICS WEB ADDRESS	http://athletics.mtsac.edu
SPECIAL EVENTS WEB ADDRESS	http://events.mtsac.edu
MT. SAC ACCESS WEB PAGE	http://events.mtsac.edu/access.htm
COLLEGE MAPS WEB ADDRESS	http://www.mtsac.edu/maps
FAX NUMBER	909.869.1076
GENERAL LOCATION	Mt. San Antonio College is located in the east San Gabriel Valley, 26 miles east of Downtown Los Angeles. The college is bounded by the 10 freeway to the north, the 57 freeway to the east and the 60 freeway to the south.



ATHLETIC SPECIAL EVENTS
 MT. SAN ANTONIO COLLEGE
 1100 NORTH GRAND AVENUE • WALNUT, CA 91789
 (909) 594-5611 ext. 4840 • (909) 468-4109 • <http://events.mtsac.edu>

SPECIAL EVENTS STAFF

MT. SAC GENERAL NUMBER
(909) 594.5611

ADMINISTRATIVE

EXECUTIVE DIRECTOR	Deborah Blackmore	dblackmore@mtsac.edu	EXT. 4630
SPECIAL EVENTS COORDINATOR	Doug Todd	dtodd@mtsac.edu	EXT. 4882
SPECIAL EVENTS EXECUTIVE TEAM	Deborah Blackmore Debbie Cavion Mike Goff Ron Kamaka Don Ruh Doug Todd Brian Yokoyama	dblackmore@mtsac.edu dcavion@mtsac.edu mgoff@mtsac.edu rkamaka@mtsac.edu donruh@aol.com dtodd@mtsac.edu byokoyama@mtsac.edu	EXT. 4630 EXT. 4355 EXT. 4356 EXT. 5367 EXT. 4840 EXT. 4882 EXT. 4022
SPECIAL EVENTS SECRETARIES	Jennie Clacken Janet Todd	specialevents@mtsac.edu	EXT. 4840

MEDICAL STAFF

MEDICAL COORDINATOR	Bill Ito	bito@mtsac.edu	EXT. 6204
---------------------	----------	----------------	-----------

SPORTS INFORMATION

SPORTS INFORMATION DIRECTOR	Brian Yokoyama	byokoyama@mtsac.edu	EXT. 4022 OR 4629
SPORTS PUBLICIST	Kelly Martinez	sportsinfo@mtsac.edu	EXT. 3498
SPORTS STATISTICIAN	Kenneth Walter	kwalter@mtsac.edu	EXT. 5114

OTHER SERVICES

FACILITIES SUPERVISOR	Jim Friesen	EXT. 5602
TICKET SUPERVISOR	Sid Young	EXT. 4470
CAMPUS SECURITY	Jeff Parker	EXT. 4233, 4299, 4555

STADIUM NUMBERS

ATHLETIC TRAINING ROOM 50G	4878
ANNOUNCER	4832
TICKET BOOTH	4880
PRESS BOX	2080, 2081, 2082, 2083, 2084, 2085

STADIUM SCHEMATIC

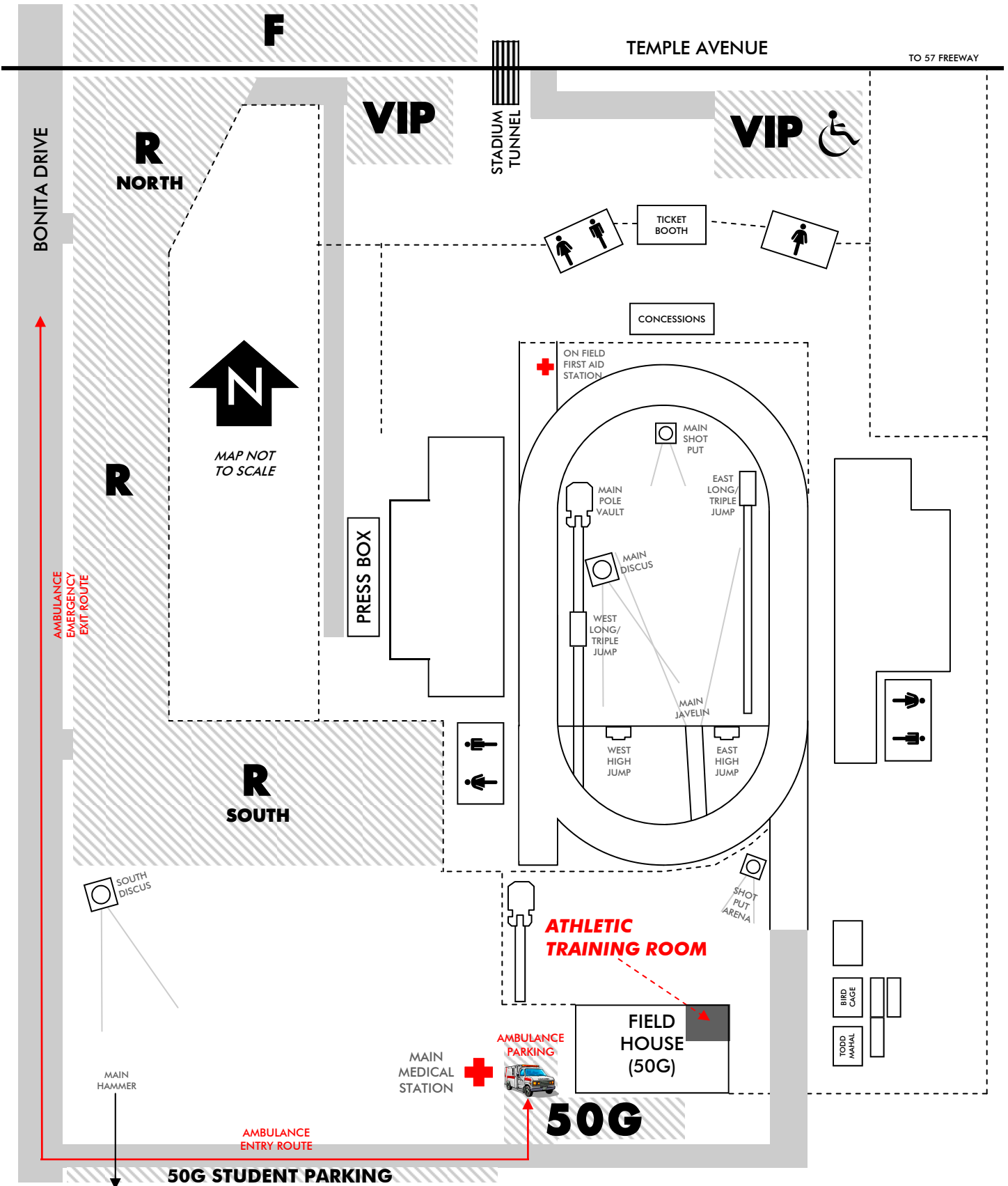

F R E E W A Y M A P

For more information including additional maps, directions to Mt. SAC and airport information please visit our Mt. SAC Access Website at <http://events.mtsac.edu/access.htm>

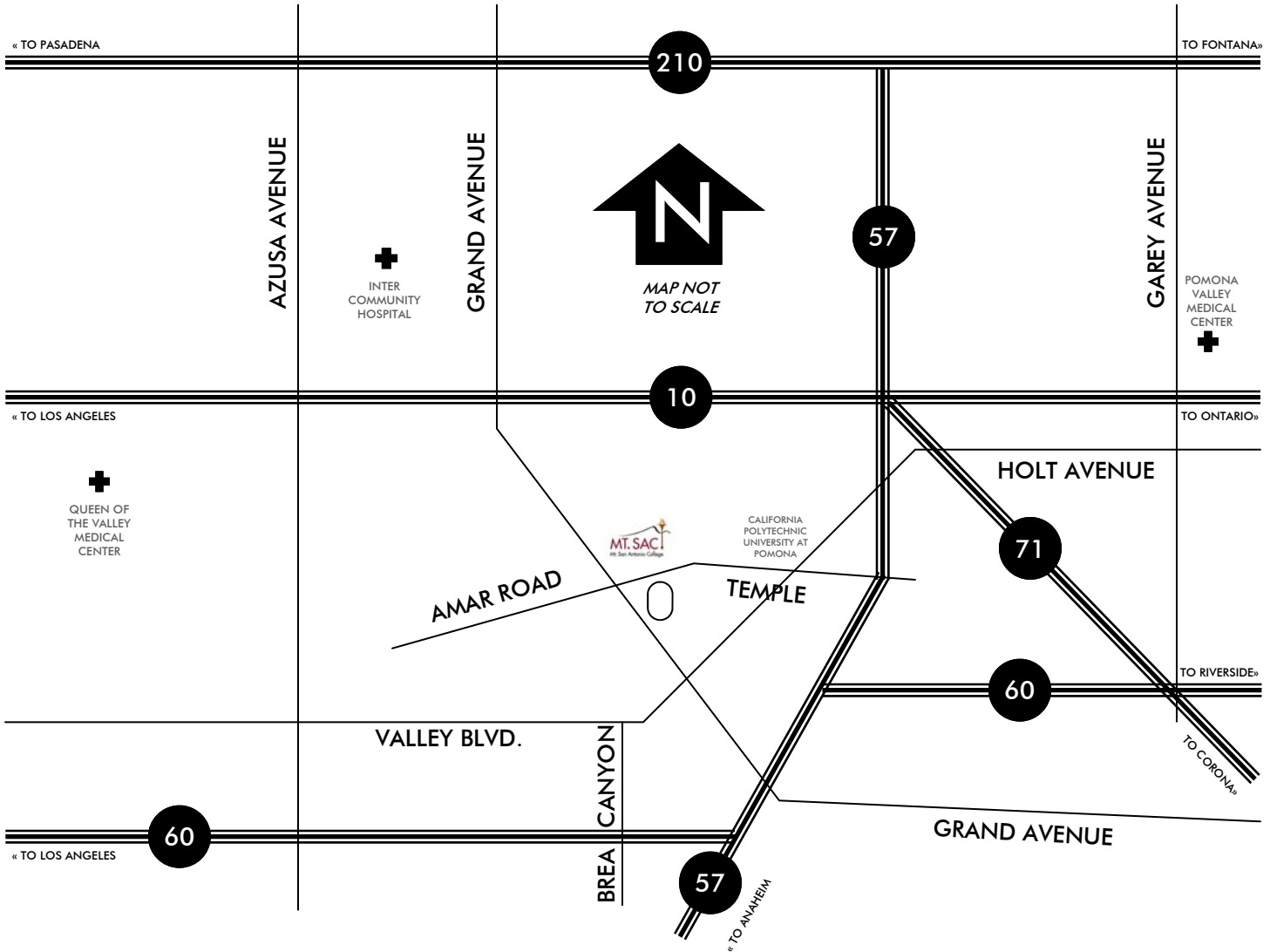

EXITS	
10 FREEWAY	• Exit Grand Avenue South
57 FREEWAY	• Exit Temple Avenue West
57 FREEWAY 60 FREEWAY (West)	• Exit Grand Avenue North
60 FREEWAY (East)	<ul style="list-style-type: none"> • Exit Brea Canyon Road North (if exiting from the west, make a left on Colima, then another left on Brea Canyon Road) • Right on Valley Blvd. (east) • Left on Grand Avenue (north)

CAMPUS MAP

For more information including additional maps, directions to Mt. SAC and airport information please visit our Mt. SAC Access Website at <http://events.mtsac.edu/access.htm>

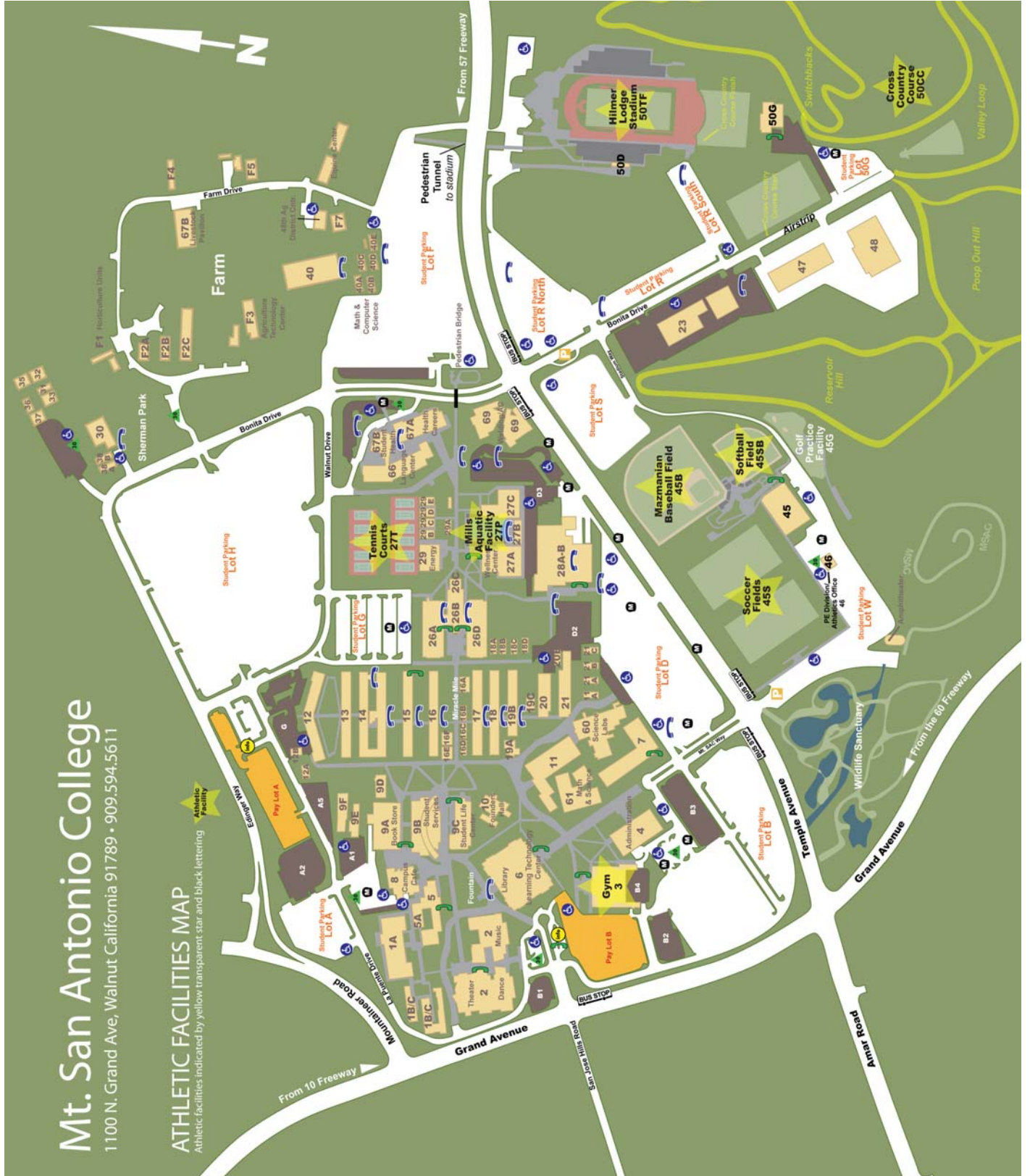

E M E R G E N C Y I N F O R M A T I O N

M T . S A C S P E C I A L E V E N T S E M E R G E N C Y I N F O R M A T I O N

EXECUTIVE DIRECTOR ATHLETIC DIRECTOR/DEAN	Deb Blackmore	dblackmore@mtsac.edu	909.594.5611 ext. 4630 951.205.9811 cell
SPECIALS EVENTS COORDINATOR	Doug Todd	dtodd@mtsac.edu	909.594.5611 ext. 4882 909.963.6579 cell
MEDICAL COORDINATOR	Bill Ito	bito@mtsac.edu	909.594.5611 ext. 6204 909.767.8883 cell
SPORTS INFORMATION DIRECTOR	Brian Yokoyama	byokoyama@mtsac.edu	909.594.5611 ext. 4022 909.896.6265 cell
EVENT SERVICES	James Gonzales	jgonzales@mtsac.edu	909.594.5611 ext. 5622 909.821.5079 cell
SECURITY/EMERGENCY	Jeff Parker	jparker@mtsac.edu	909.594.5611 ext.. 4233, 4299, 4555

P O M O N A V A L L E Y H O S P I T A L M E D I C A L C E N T E R

ADDRESS	1798 North Garey Avenue • Pomona, CA 91767
GENERAL NUMBER	909.865.9500
EMERGENCY NUMBER	909.865.9600
DIRECTIONS FROM MT. SAC (6.8 Miles Away)	<ul style="list-style-type: none"> • Temple Avenue (east) • 57 Freeway North • 10 Freeway East • Exit Garey North (left) • Hospital is on the right hand side 1 block north of the freeway

C I T R U S V A L L E Y M E D I C A L C E N T E R

ADDRESS	1115 Sunset Avenue • West Covina, CA 91790
GENERAL NUMBER	626.962.4011
EMERGENCY NUMBER	626.962.4011
DIRECTIONS FROM MT. SAC (7.5 Miles Away)	<ul style="list-style-type: none"> • Grand Avenue North • Left on Cameron (west) • Left on Sunset (south) • Hospital is on the right hand side on the corner of Merced and Cameron

I N T E R - C O M M U N I T Y H O S P I T A L

ADDRESS	210 West San Bernardino Road • Covina, CA 91723
GENERAL NUMBER	626.331.7331
EMERGENCY NUMBER	626.331.7331
DIRECTIONS FROM MT. SAC (7.5 Miles Away)	<ul style="list-style-type: none"> • Grand Avenue North • Left on San Bernardino Road (west) • Hospital is just past Citrus Avenue on the left hand side.

S E R V I C E S I N F O R M A T I O N

H O T E L S A N D C A R R E N T A L

FOR THE LATEST HOTEL AND RENTAL CAR INFORMATION
PLEASE VISIT OUR WEBSITE AT:

<http://events.mtsac.edu>

Mention "Mt. SAC Special Events" to receive the lowest rate.
Rates subject to change

S U P E R M A R K E T S

STATER BROTHERS	20677 Amar Rd . • Walnut	909.598.6534
-----------------	--------------------------	--------------

L A R G E S H O P P I N G M A L L S

EASTLAND SHOPPING CENTER	Directly north of the 10 Freeway, between Barranca and Citrus Exits	Ross, Marshalls, Burlington Coat Factory, Target, Dicks Sporting Goods, Bed Bath and Beyond
WEST COVINA PLAZA	Directly south of the 10 Freeway, Between Vincent and Sunset Exits.	Sears, Macy's, JC Penney's, Sports Authority, Steve and Barry's, Footlocker
PUENTE HILLS MALL	Directly south of the 60 Freeway, off of the Azusa Exit.	Macy's, Sears, Circuit City, Costco, AMC 30 Theater, Burlington Coat Factory, Footlocker

S E R V I C E S I N F O R M A T I O N

RECOMMENDED RESTAURANTS (BY MT. SAC ATHLETICS STAFF)

BANGKOK BBQ	****	Thai	\$	909.468.9784	372 N. Lemon Ave. • Walnut
BELLA NAPOLI PIZZA	***	Italian	\$	909.594.1950	515 N. Grand Ave. • Walnut
BJ'S BREWERY	****	American	\$\$	626.967.5530	2917 E. Eastland Center Dr. • West Covina
CHICK-FIL-A	***	American	\$	909.598.6300	21550 Valley Blvd. • City of Industry
CHILI'S	***	American	\$\$	626.915.8809	2929 E. Garvey Ave. • West Covina
CHIPOTLE	***	Mexican	\$	909.595.1502	21710-A Valley Blvd • Walnut
CIMA	*****	Pacific Fusion	\$\$\$\$\$	626.854.2335	1 Industry Hills Pkwy • City of Industry
D'ANTONIO'S	*****	Italian	\$\$\$	909.860.3663	808 N. Diamond Bar Blvd. • Diamond Bar
DOCKSIDE GRILL	****	Seafood	\$\$\$	626.915.3474	3057 E. Garvey Ave. • West Covina
HAYAKAWA	*****	Japanese	\$\$\$	626.332.8288	750 Terrado Plaza, Suite 33 • Covina
HOUSE OF LOUIE	*****	Chinese	\$\$\$	626.339.7374	128 N. Grand Ave. • Walnut
IN-N-OUT BURGER	*****	Hamburgers	\$	800.786.1000	21620 Valley Blvd. • City of Industry
ISLANDS	****	Hamburgers	\$\$	626.331.6223	139 N. Barranca St. • West Covina
KYALA	****	Japanese	\$\$	909.860.9162	1178 S. Diamond Bar Blvd. • Diamond Bar
L&L HAWAIIAN BBQ	****	Hawaiian	\$	909.444.0030	515 N. Grand Ave. Unit C • Walnut
MILLIE'S	***	Family	\$\$	909.594.0322	21627 Valley Blvd. • Walnut
MJ RANCH	***	Barbeque	\$\$	626.331.7371	3101 E. Garvey Ave. • West Covina
NEW YORK PIZZERIA	***	Pizza	\$	909.594.5000	364 N. Lemon Ave. • Walnut
OLD WORLD DELI	****	Deli	\$\$	626.967.6307	2648 E. Workman Ave • West Covina
PANDA EXPRESS	***	Chinese	\$	909.595.1633	558 N. Grand Ave. • Walnut
PHILLY'S BEST	****	American	\$	909.598.3650	368 N. Lemon Ave., Unit B • Walnut
PICK UP STIX	****	Chinese	\$	626-339-3383	143 N. Barranca St. Suite B • West Covina
ROBEKS	*****	Smoothies	\$	909.869.7773	505 N. Grand Avenue, Suite B • Walnut
SCOREBOARD	***	American	\$\$	909.468.0444	3220 Temple Ave. • Pomona
SUBWAY	***	American	\$	909.595.9375	1219 N. Grand Ave. • Walnut
TACO FACTORY	***	Mexican	\$	909.595.8331	380 N. Lemon Ave. • Walnut
TACO NAZO	***	Mexican	\$	909.595.0555	1267 N. Grand Ave. • Walnut
TASTE OF TEXAS	****	Tex-Mex	\$	626.331.2824	545 N. Citrus Ave. • West Covina
TGI FRIDAY'S	****	American	\$\$	626.331.6393	2625 E. Eastland Center Dr. • West Covina
YAMA BOWL	***	Japanese	\$	909.595.3700	1225 N. Grand Ave. • Walnut
YUMMY HOUSE	****	Chinese	\$\$	909.468.4491	20781-2 Amar Road • Walnut

COST FOR 1 PERSON (DINNER): \$=\$4-\$8 • \$\$=\$9-\$15 • \$\$\$=\$16-\$22 • \$\$\$\$=\$21-\$30 • \$\$\$\$\$=\$31+
Each restaurant was rated within their cost category: * = VERY GOOD **** = GREAT ***** = SUPERB**



ATHLETIC SPECIAL EVENTS
MT. SAN ANTONIO COLLEGE
1100 NORTH GRAND AVENUE • WALNUT, CA 91789
(909) 594-5611 ext. 4840 • (909) 468-4109 • <http://events.mtsac.edu>